



## GOLDSTRIKE™ DRINK HOLDER

### Parts Included:

- 1 Accessory Perch Mount
- 2 M6 x 45mm Bolts
- 2 Spacers

### Installation Instructions:

1. Remove the plastic bolt cover on your controls using your fingernail or screwdriver. (Fig. 1)
2. Remove the top 6mm bolt. (Fig. 2)

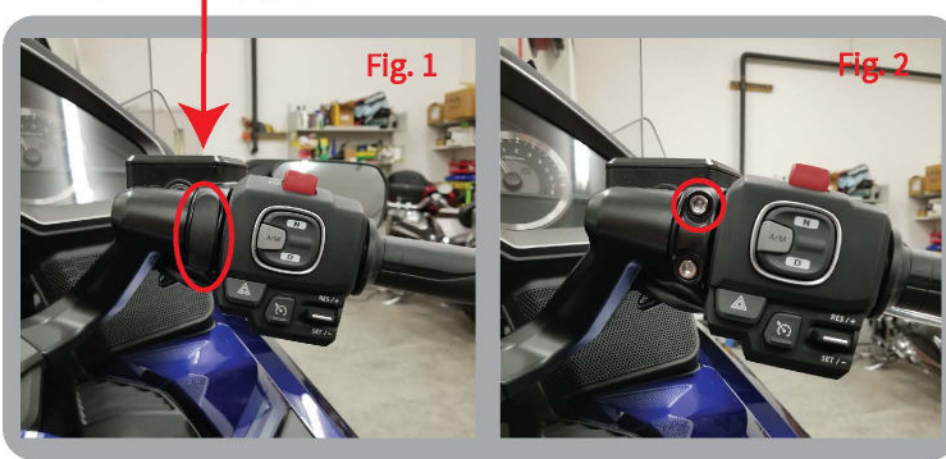

3. Put the included M6 bolt through the top hole of the perch mount, then slide the spacer over it. (Fig. 3)
4. Install the perch mount where you removed the stock bolt using a 5mm allen. Leave loose at this time. (Fig. 4)



5. Remove the lower stock control bolt and install the included M6 bolt and spacer. You may now tighten both the upper and lower bolts. (Fig. 5)
6. Adjust the angle of the ball mount to your desired position and tighten the 4mm bolt. (Fig. 6)



**DO  
NOT  
OVERTIGHTEN**

### WARNING:

This indication alerts you to the fact that ignoring the contents described herein can result in potential serious injury or death if not followed.

### CAUTION:

This indication alerts you to the fact that ignoring the contents described herein can or will result in material damage and/or personal injury.

### ATTENTION:

This indication alerts you to the fact if you ignore this detail you will affect the performance or functionality of the product.

All Ciro products are designed for "easy assembly" and/or "plug and play". We recommend a competent mechanic install our products, using standard mechanical procedures to assure a safe and successful installation.

### NOTE:

Ciro products are designed and manufactured under very strict quality control. Ciro warrants that products sold to the original purchaser shall be free from any defects in materials and workmanship for a period of 3 (three) years from the date of purchase, and a lifetime warranty against LED failure. Ciro will have no obligation if the customer cannot show proof of purchase. Warranty will not be granted unless the part is properly installed and maintained. Ciro will not be liable for any consequential and incidental damages, including labor, or non-Ciro products. Please visit our website [Ciro3d.com](http://Ciro3d.com) for our complete warranty policy.



## **GOLDSTRIKE™ SMARTPHONE HOLDER**

### **Parts Included:**

- 1 Smartphone Holder Assembly

### **Installation Instructions:**

1. Remove the large plastic nut from your smartphone holder and slide it over the ball mount with the threads facing outward.

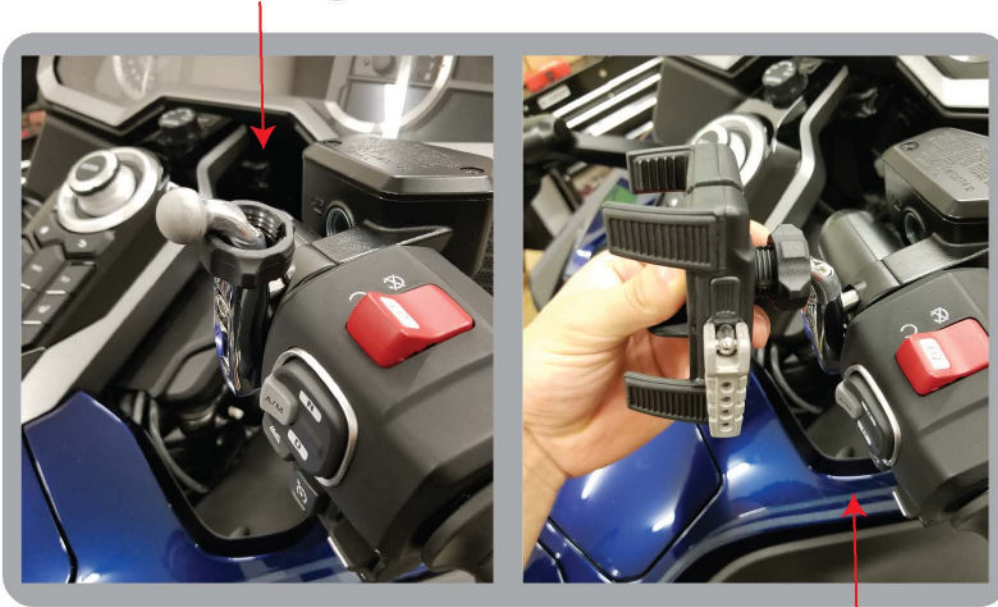

2. Snap your smartphone holder onto the ball and thread the large plastic nut onto the smartphone holder. Adjust the angle and tighten it down.
3. Flip up the side lever on the smartphone holder and adjust it to the size of your phone. Your device should have just enough space to slide in and out. When adjusted correctly, flip the lever down to secure your device.

\*Note: The lever can be put on either side if unscrewed all the way.

### **WARNING:**

This indication alerts you to the fact that ignoring the contents described herein can result in potential serious injury or death if not followed.

### **CAUTION:**

This indication alerts you to the fact that ignoring the contents described herein can or will result in material damage and/or personal injury.

### **ATTENTION:**

This indication alerts you to the fact if you ignore this detail you will affect the performance or functionality of the product.

All Ciro products are designed for "easy assembly" and/or "plug and play". We recommend a competent mechanic install our products, using standard mechanical procedures to assure a safe and successful installation.

### **NOTE:**

Ciro products are designed and manufactured under very strict quality control. Ciro warrants that products sold to the original purchaser shall be free from any defects in materials and workmanship for a period of 3 (three) years from the date of purchase, and a lifetime warranty against LED failure. Ciro will have no obligation if the customer cannot show proof of purchase. Warranty will not be granted unless the part is properly installed and maintained. Ciro will not be liable for any consequential and incidental damages, including labor, or non-Ciro products. Please visit our website [Ciro3d.com](http://Ciro3d.com) for our complete warranty policy.

**CIRO3D.COM**